

Residential Deck

1210 Maryland Ave N.E Washington D.C. 20002

SCOPE OF WORK

1. Add new deck to rear of home.
2. Exterior work only.

ABBREVIATIONS REFERENCE

ABV	Above	DV	Division	INT	Interior	PT	Pressure Treated
AF	Above Floor	DWR	Drawer	E.K	Interior	PID	Polled
ASF	Above Finished Floor	DWG	Drawing	INTAL	Intermediata	PVC	Polyvinyl Chloride
ASCC	Above Suspended Ceiling	EF	Each Face	INV	Invert	PCF	Pounds Per Cubic Foot
ACC	Access	EPS	East	IPN	Iron Pipe Size	PFL	Pounds per Lineal Foot
ACFL	Access Floor	ELEC	Electric (el)	JT	Joint	REM	Reins
AC	Accoualool	EP	Electric Panelboard	JF	Joint Filler	RES	Resilient
ACPL	Accoualool Plaster	EW	Electric Water Cooler	J	Joint	RET	Return
ADD	Addendum	EDL	Electric Door Lock	JB	Junction Box	RJ	Radiation Joint
ADH	Adhesive	EL	Elevation	LAD	Ladder	RVS	Reverse (side)
ADHA	Adhesive Applied	EMER	Emergency	L	Length	REV	Revision (s), (r), (w)
ADJ	Adjacent	EC	Emergency Conduit	LB	Lag Bolt	RH	Right Hand
ADJT	Adjustable	ENC	Enclosure (ure)	LAM	Laminata (d)	R	Riser
ADD	Aggregate	EQ	Equal	LH	Left Hand	RVT	Rivet
AI	Air Inlets	ESP	Equipment	L	Light	RFG	Roofing
ALT	Altitude	EST	Estimate	LT	Light	RV	Roof Vent
AL	Aluminum	EXCA	Excavate	LC	Light Control	RO	Rough Opening
ANC	Anchor (one)	EXH	Exhaust	LP	Lightproof	RWC	Rubberstar Conductor
ANB	Anchor Bolt	EXL	Exhaust	LQ	Lightweight	SNT	Sedent
ANOD	Anodized	EXST	Expansion Joint	LW	Light Weight Concrete	SCF	Seamless Copolymer Floor
APPL	Applied	EXMP	Expanded Metal Plate	LWP	Light Weight Plaster	SD	Section
APX	Approximate	EB	Expansion Bolt	LPT	Low Point	SCS	Sheet
ARCH	Architect (prof)	EXP	Exposed Structure, Painted	M	Main	SH	Shore (d), (ng)
ARCHS	Architectural Cast Stone	EXSP	Exposed Structure, Painted	MOP	Main Distribution Panel	SHO	Shore (d), (ng)
ARCHCS	Architectural Cast Stone	EXT	Exterior	MLO	Main Lugs Only	SM	Similar
ARCHCO	Architectural Concrete	EXS	Extra Strong	M	Masonry	SP	Soil Pipe
AD	Area Drain	FC	Face of Concrete	MH	Manhole	SP	Soundproof
ASPH	Asphalt	FCF	Face of Finish	MFR	Manufacturer	S	South
AUTO	Automatic	FGL	Fiber Glass	MTL	Metal (s)	S	South
BSMT	Basement	FIN	Finished	MAX	Maximum	SPC	Spacer
BSM	Beam	FFE	Finished Floor Elevation	MECH	Mechanic (of)	SPK	Speaker
BRG	Bearing	FFL	Finished Floor Line	MED	Medium	SPL	Special
BPL	Bearing Plate	FFS	Finished Grade	MGR	Member	SPEC	Specification
BUT	Butt Joint	FA	Fire Alarm	MMS	Membrane	SQ	Square
BMK	Bench Mark	FDT	Fire Detector	MET	Metal	SS	Stainless Steel
BET	Between	FD	Fire Damper	MIFR	Metal Furring	STD	Standard
BVL	Beveled	FE	Fire Extinguisher	MIP	Metal Partition	ST	Steel
BT	Bituminous	FF	Fine Finish	MTHR	Metal Threshold	STD	Storm Drain
BLDG	Building	FRC	Fire-Resistant Coating	M	Meter (s)	STR	Structural
BD	Board	FRT	Fire Retardant Coating	MM	Millimeter (s)	SUS	Suspended
BS	Both Sides	FLS	Flashing	MN	Minimum	SYM	Symmetry (roof)
BT	Both Ways	FRMS	Flashed Machine Screw	MISC	Miscellaneous	SYN	Synthetic
BOT	Bottom	FRS	Flashed Wood Screw	MCD	Modular	SYS	System
BLDG	Building	FLX	Flexible	MLD	Molding, Molding	TEL	Telephone
BUR	Built Up Roof	FLR	Floor (ing)	MR	Map Receptor	TE	Television
BL	Building Line	FLDO	Floor Cleanout	MT	Mount (ed), (ing)	THK	Thick (ness)
BDD	Building Board	FD	Floor Drain	MOV	Movable	THR	Threshold
CLS	Calling	FH	Floor Hinge	MULL	Mullion	TR	Tray & Groove
CHT	Calling Height	FHP	Floor Hinge Pocket	NL	Nalobie	TS	Top of Slab
CEM	Cement	FPL	Floor Plate	NAT	Natural	TS	Top of Slab
PCPL	Cement Plaster (Portland)	FLLR	Fluorescent	NEC	National Electric Code	TS	Top of Slab
CM	Cast-in-place (s)	CM	Cast-in-place (s)	NF	Near Face	TR	Transverse
CR	Circle	FND	Foundation	NI	Nical	TGS	Tread
CNBL	Cinder Block	FR	Frame (d), (ing)	NR	Noise Reduction	TYP	Typical
CKT	Circuit	FRA	Fresh Air	NRC	Noise Reduction Coefficient	UC	Undercut
C/B	Circuit Breaker	FS	Full Size	NOM	Nominal	UNF	Unfinished
CRC	Circumference	FBO	Furnished By Others	NFSS	Non-Fused Safety Switch	UN	Unlabeled
CO	Clean Out	FLR	Furred (ing)	NMT	Nonmetallic	UNO	Unless Otherwise Noted
CLR	Clear (ance)	FSS	Fused Safety Switch	N	North	VCT	Vinyl Base
CLGL	Clear Glass	FUT	Future	NIC	Not in Contract	VB	Vapor Barrier
CLGL	Clear Wire Glass	GA	Gage, Gauge	NTS	Not to Scale	VT	Vapor Tight
CLL	Closure	GV	Galvanized	OC	Obscure	VNR	Vertical
COL	Column	GI	Galvanized Iron	OC	On Center	VNT	Vertical
COMB	Combination	GP	Galvanized Pipe	OP	Opaque	VNR	Vertical
COMPT	Compartment	GS	Galvanized Steel Sheet	OPG	Opening	VNT	Vertical
COMPO	Composition (Composite)	GKT	Gasket (ed)	OJ	Open-Web Joist	VP	Vent Pipe
COMP	Compress (ed), (ion), (ible)	GC	General Contract (or)	OP	Opposite	VENT	Ventilator
CONC	Concrete	GL	Glass, Glazing	OPH	Opposite Hand	VER	Vertical
CONCP	Concrete Painted	GB	Grab Bar	OPS	Opposite Surface	VER	Vertical
CF	Conductive Flooring	GD	Grade, Grading	OD	Outside Diameter	VERT	Vertical
CAU	Concrete Masonry Unit	GV	Gravel	OMS	Overhead Machine Screw	VG	Vertical Grain
CK	Connection	GF	Ground Face	OWS	Overhead Wood Screw	WTW	Wall to Wall
CONCT	Contract (or)	GT	Grout	OH	Overhead	WH	Wall Hung
CONJ	Construction Joint	GT	Grout	OH	Overhead	WP	Waterproofing
CONT	Continuous or Continue	GWB	Gypsum Wall board	OH	Overhead	WR	Water Resistant
CONTR	Contract (or)	H	Hand	OH	Overhead	WTP	Waterstop
CLL	Contract Line Limit	HED	Handboard	PLA	Plaster	WT	Weight
CT	Control Joint	HWR	Hardware	PL	Panel	WVF	Welded Wire Fabric
CG	Corner Guard	HWD	Hardware	PL	Panel	W	West
CORR	Corrugated	HJT	Head Joint	PK	Parking	WN	Window
CFT	Cubic Foot	HDR	Header	POW	Part of Window	WG	Wire Glass
CYD	Cubic Yard	HT	Height	PB	Partic Board	WM	Wire Mesh
DPR	Damper	HE	Header	PTN	Partition	WO	Without
DP	Dampening	HC	Hollow Core	PV	Pave (d), (ing)	WO	Wood
DL	Dead Load	HM	Hollow Metal	PVMT	Pavement	WB	Wood Base
DEM	Demolish, Demolition	HK	Hook (s)	PE	Partic	WPT	Working Point
DMT	Demountable	HOR	Horizontal	PERE	Partic (d)	W	Wrought Iron
DEP	Depressed	INCL	Inch (s), (ing)	PERI	Partic (d)	YD	Yard Drain
DTL	Detail	ID	Inside Diameter	PL	Plate		
DLAG	Diagonal	INS	Insulate (d), (ion)	PG	Plate Glass		
DM	Dimension	ISC	Insulating Concrete	PWD	Plywood		
DPR	Dispenser	ISF	Insulating FIB				

SYMBOLS LIST

①	REFERS TO DRAWING NOTES	=====	EXISTING WALL TO REMAIN
◇	RO LIGHT FIXTURE - (R) RECESSED	=====	NEW INTERIOR WALL - (SEE WALL TYPE DETAILS)
□	FLOURESCENT LIGHT FIXTURE	=====	EXISTING WALL TO BE REMOVED
⊕	LIGHT SWITCH	⊕	DOOR SIZE - SEE SCHEDULE
⊖	THERMOSTAT	(E)	EXISTING (TYPICAL)
⊙	CEILING MTD. SMOKE DETECTOR	(ER)	EXISTING TO RELOCATE (TYPICAL)
⊙	CEILING MTD. CARBON D/SMOKE DETECTOR	(RR)	EXISTING TO REMOVE AND RELOCATE (TYPICAL)
⊙	WALL MTD. DETECTORS	(N)	NEW (TYPICAL)
⊙	DUPLEX RECEPTACLE	⊕	NEW TO EXISTING CONNECTION
⊙	ELECT. RANGE RECEPTACLE	=====	WALL/CEILING REGISTER
⊙	DISHWASHER RECEPTACLE	-----	DUCTWORK - EXISTING SHOWN DASHED
⊙	MICROWAVE RECEPTACLE	-----	"B" VENT & EXHAUST DUCTWORK - EXIST. SHOWN DASHED
⊙	TRIPLEX RECEPTACLE	⊕	SUPPLY AIR REGISTER/DIFFUSER
⊙	GROUND FAULT RECEPTACLE	⊕	RETURN AIR REGISTER/DIFFUSER
⊙	ARC FAULT CIRCUIT INTERRUPTER	⊕	10' FIRE ALARM GONG
⊙	CLOTHES DRYER RECEPTACLE	⊕	MTD. 10' ABV. GRADE
⊙	CLOTHES WASHER RECEPTACLE	⊕	STROBE LIGHT CONNECTED TO FIRE ALARM SYSTEM WITH BATTERY BACK-UP
⊙	REFRIGERATOR RECEPTACLE	⊕	FIRE ALARM PULL STATION & GONG
⊙	GARBAGE DISPOSAL SWITCH	⊕	EMERGENCY WHITE
⊙	RANGE HOOD RECEPTACLE	=====	INTERIOR 2-HR. RATED WALL - (SEE DETAIL)
⊙	NEW TELEPHONE JACK	=====	FIRE EXTINGUISHER
⊙	NEW COMBO CABLE TV/CAT-7 NETWORK JACK	=====	EMERGENCY LIGHTS w/EXIT SIGN w/BATTERY BACK-UP, ARROW INDICATES DIRECTION
⊕	HEAT DETECTOR	=====	WIRELESS ACCESS POINT
⊕	MANUAL PULL STATION FOR ANSUL	=====	EXIT SIGN w/DIRECTION ARROW
⊕	WALL TYPE SYMBOL		
FAAP	FIRE ALARM ANNUNCIATOR PANEL		
FACP	FIRE ALARM CONTROL PANEL		

SITE PHOTOS

BUILDING ZONE & CODE ANALYSIS

ZONE ANALYSIS

BUILDING USE GROUP: ----- RESIDENTIAL-CONVERSION-Meth5
 HT./No. OF STORIES: ----- 2 - STORY
 HIGH RISE: ----- NO
 COVERED MALL: ----- NO
 GROSS BLDG. AREA: ----- UNKNOWN
 MAX. EXIT LENGTH: ----- 40 FT.
 SQUARE: ----- 0916
 LOT: ----- 0081
 PERCENTAGE OF LOT OCCUPANCY: ----- N/A
 LAND AREA: ----- 11,457 SQ.FT.
 YEAR BUILT: ----- UNKNOWN
 ZONE: ----- RF-1

CODE ANALYSIS

BUILDING CODE DESIGN ----- BUILDING CODE IBC 2012 & DCMR 12-2013 SUPPLEMENT
 DATA: ----- DCMR 12-2013 SUPPLEMENT (EXISTING BUILDING)
 MECHANICAL: IMC 2012 & DCMR 12F-2013 12E-2013 SUPPLEMENT
 PLUMBING: IPC 2012 & DCMR 12F-2013 SUPPLEMENT
 ELECTRICAL: NFPA, NEC 2012 & DCMR 12F-2013 SUPPLEMENT
 FIRE: IFC 2012 & DCMR 12I-2013 SUPPLEMENT
 ACCESSIBILITY: ANSI 117.1-2012 & DCMR 12 A-2013 SUPPLEMENT

EXTERIOR/FIRE SEPARATION WALL: ----- 2-HRS.
 TENANT SEPARATION WALL: ----- N/A
 INTERIOR BEARING PARTION: ----- 1-HR.
 STRUCTURAL MEMBERS SUPPORTING WALL: ----- 2-HRS.
 ROOF CONSTRUCTION, BEAMS, TRUSSES FRAMING, AND ROOF DECK: --- 0-HRS.
 NUMBER OF EXITS: ----- 2
 SUPPRESSED: ----- NO
 BUILDING CONSTRUCTION TYPE: ----- III B
 WARD: ----- 6

INDEX OF DRAWINGS

Sheet no.	Description
CS1.0	Cover sheet, abbreviations and symbols list
A1.0	Deck plan, stair detail, deck section detail
A2.0	Rail detail, sub-frame details

A3.0 Framing Details

Notes

Property address
 1210 Maryland Avenue
 Washington D.C. 20002

Owner
 Elderidge Nichols

Date
 2/03/2018

Sheet
 CS1.0

Figure 33: Guard Construction

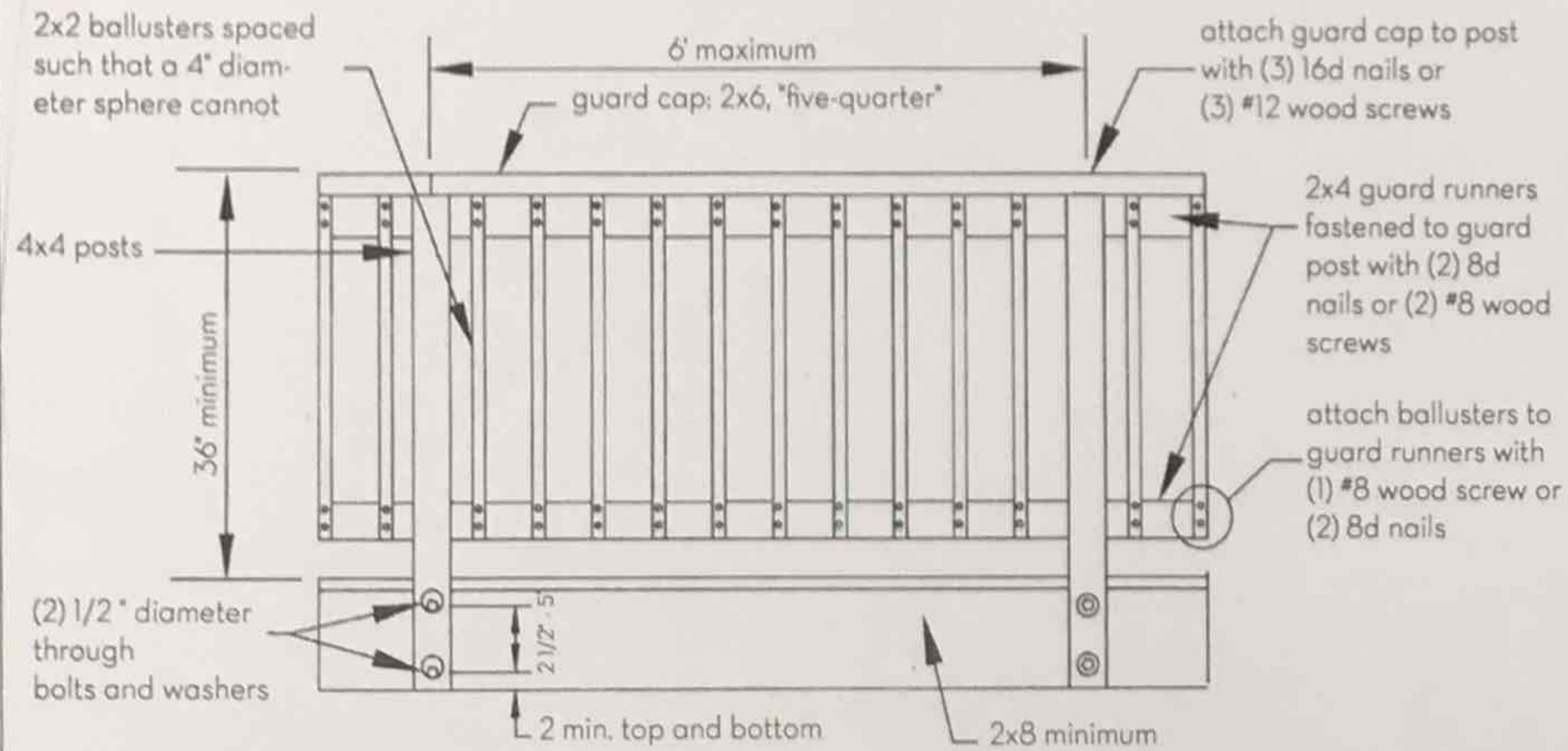

Figure 41: Stair

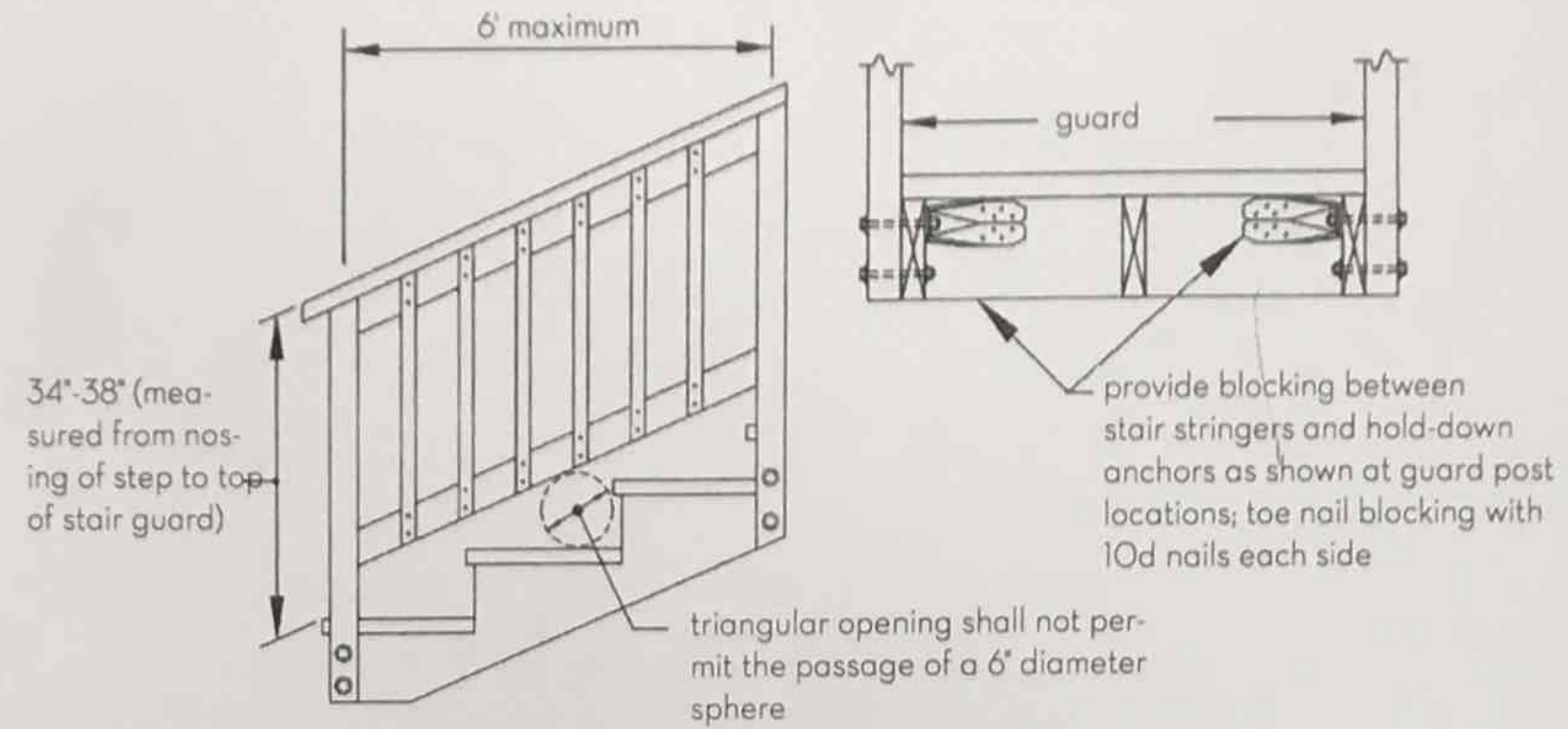

Figure 42: Handrails

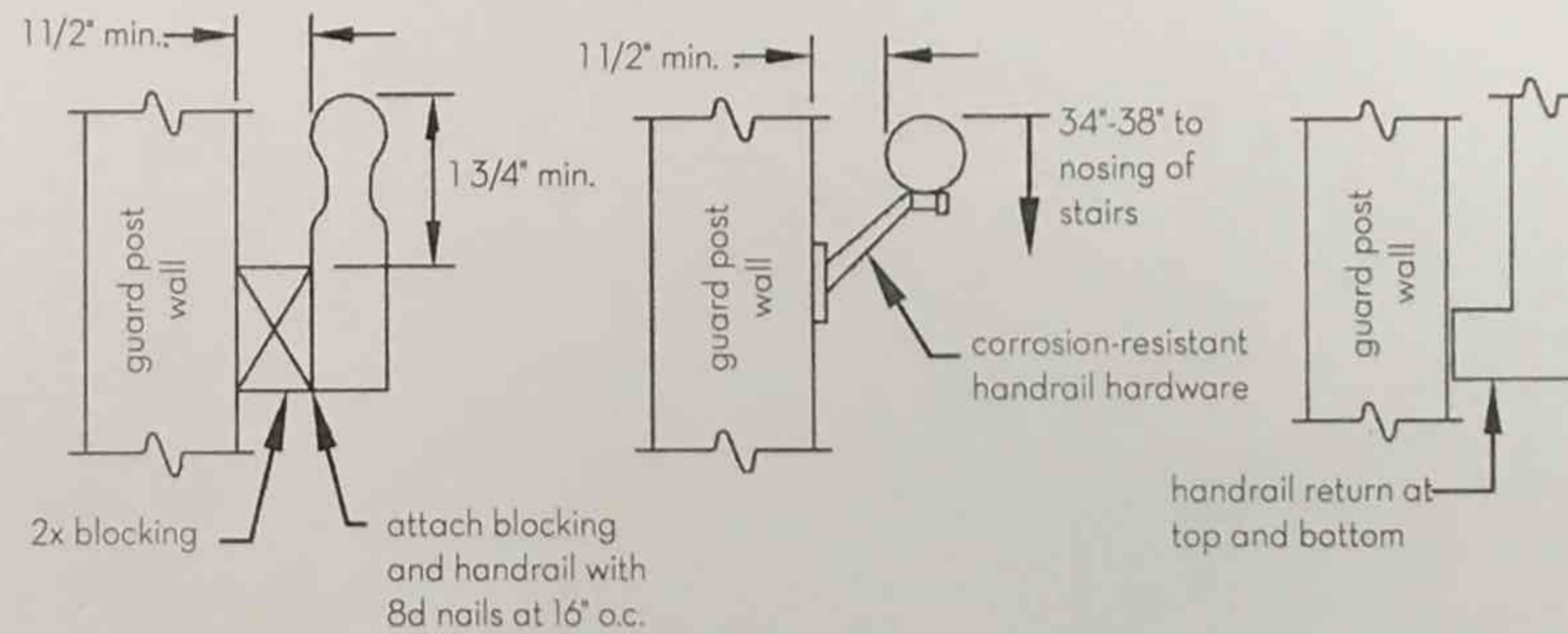

Figure 35: Guard Post -to- End Joist¹

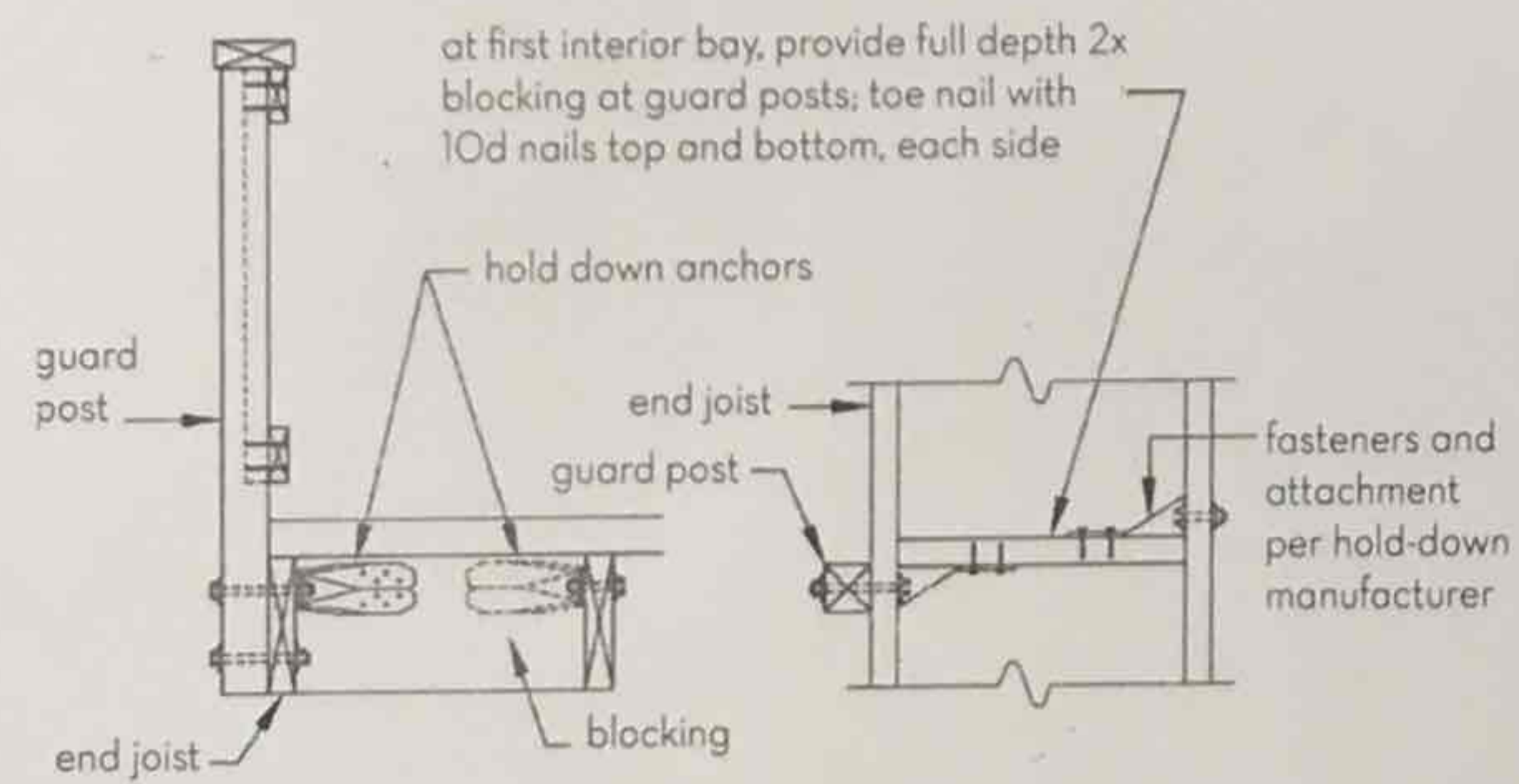
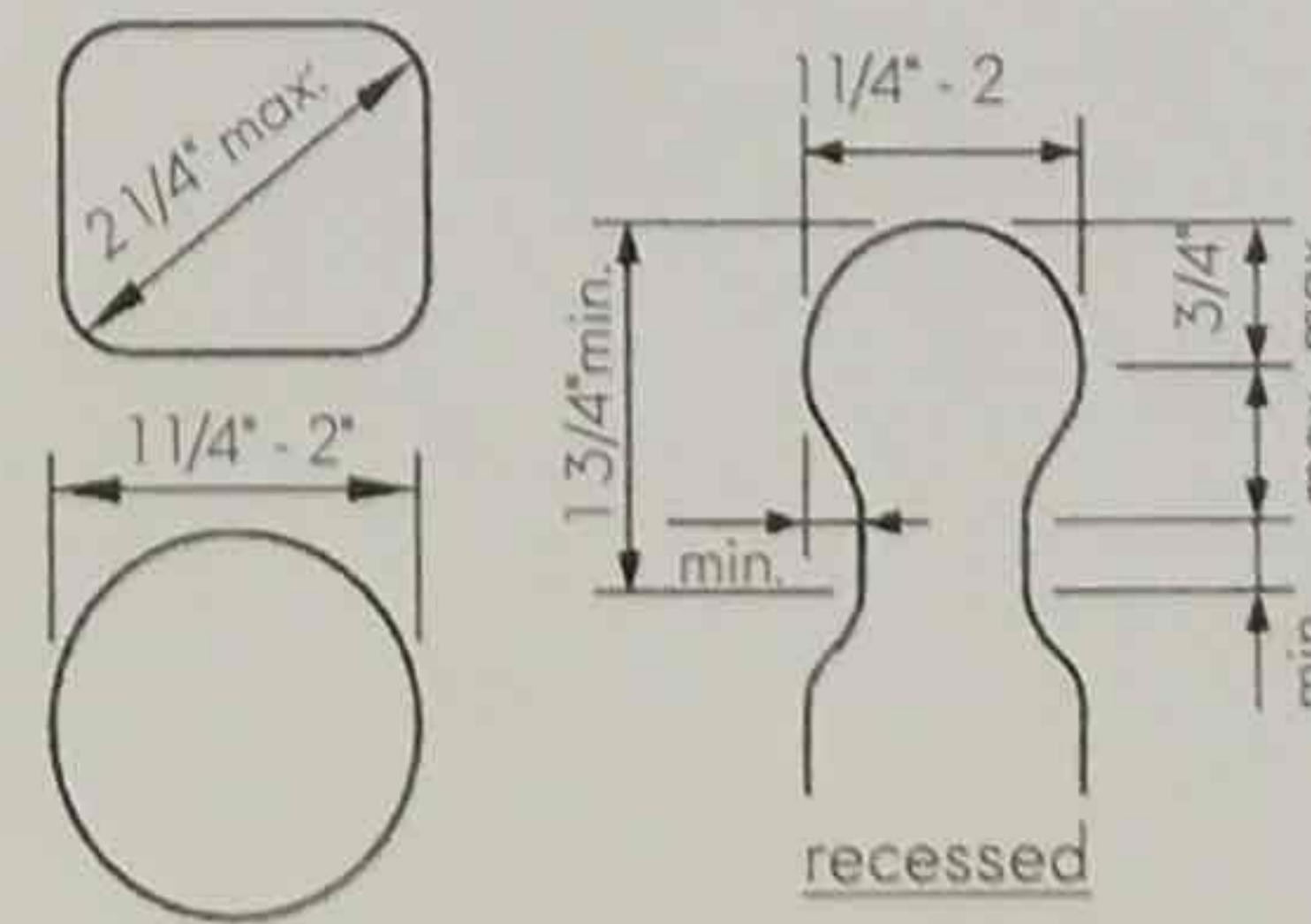

Figure 43: Handrail Graspability



Notes

Property address 1210 Maryland Avenue Washington D.C.20002	
Owner Elderidge Nichols	
Date 2/03/2018	
Sheet A2.0	

Hand and Deck Details

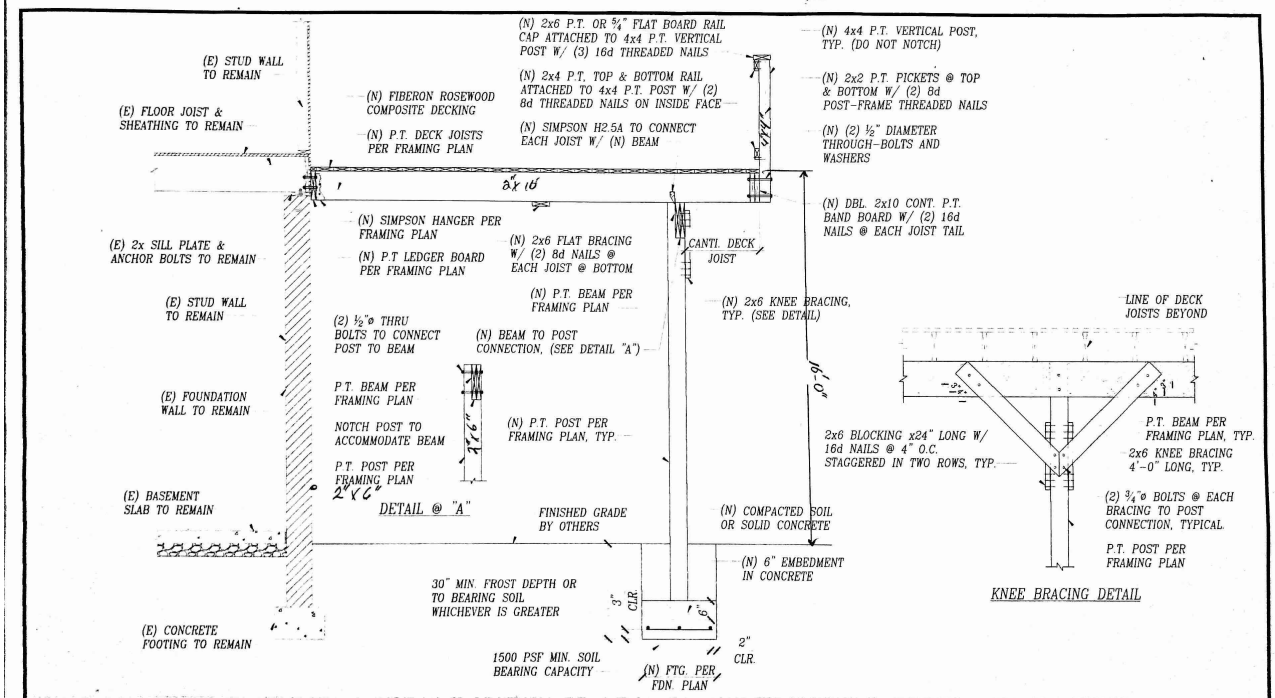

1 DETAIL @ NEW DECK

SHEET NO	DATE	REVISION	DETAIL @ NEW DECK
A 4.0	05/00/18	AS NOTED	ADDRESS: 1210 Maryland Ave, NE.
DRAWN BY	ANDY	REV. NO.	CLIENT: KEVIN THOMAS
CHECKED BY	ANDY	DATE	

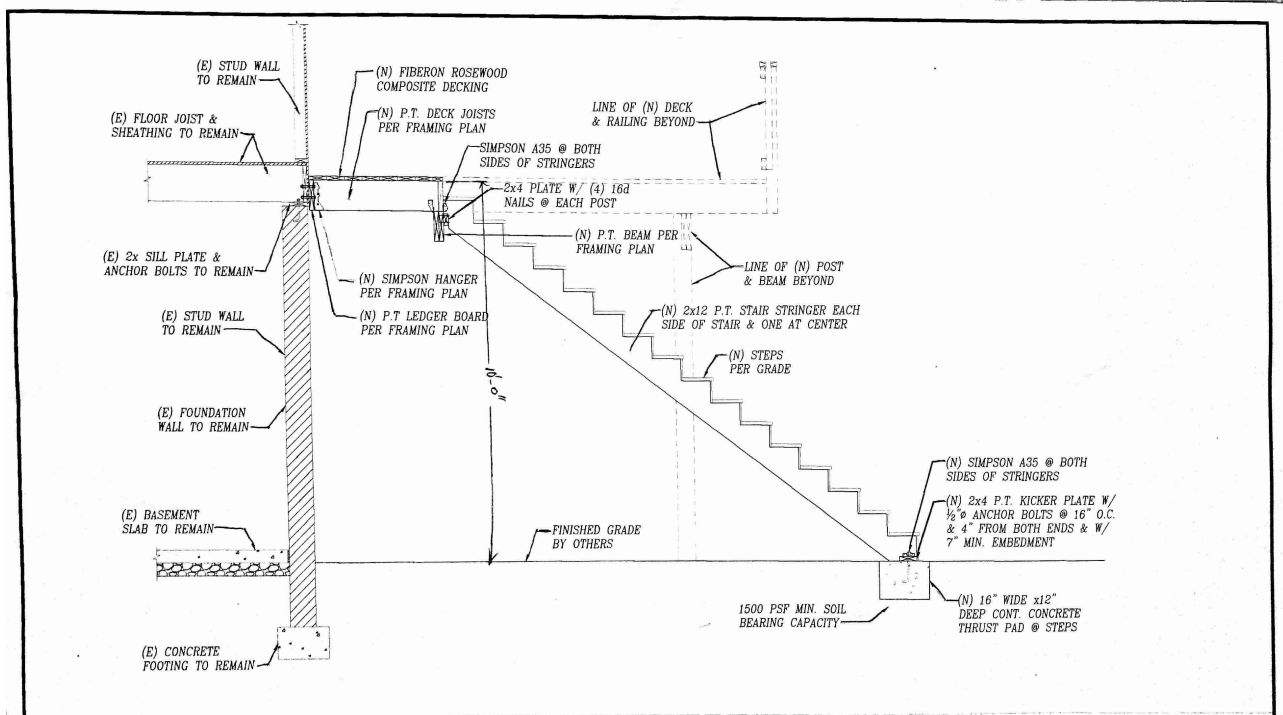

1 DETAIL @ NEW STAIR

SHEET NO	DATE	05/09/18	REVISION		DETAIL @ NEW STAIR	
A5.0	SCALE	3/8" = 1"	AS NOTED	REV. NO.	DATE	ADDRESS: 1210 Maryland Ave NE.
	DRAWN BY	ANDY	-	-	-	CLIENT: KEVIN THOMAS
	CHECKED BY	ANDY	-	-	-	